

Service
Service
Service



Philips Consumer Lifestyle

Service Manual

PRODUCT INFORMATION

General:

- Mains operation only
- World wide automatic voltage selection 100 - 240 Volt

Safety info

- This product meets the requirements regarding interference suppression on radio and TV.
- After the product has been repaired, it should function properly and has to meet the safety requirements as officially laid down at this moment.

TECHNICAL INFORMATION

- Voltage : 100 - 240 Volt
- Motor voltage : 2,4 Volt
- Cutter need no oiling

DISASSEMBLY- AND RE-ASSEMBLY ADVICE

- No specific issues

REPAIR INSTRUCTIONS

- No specific issues

OPTIONAL (accessories)

- No specific issues

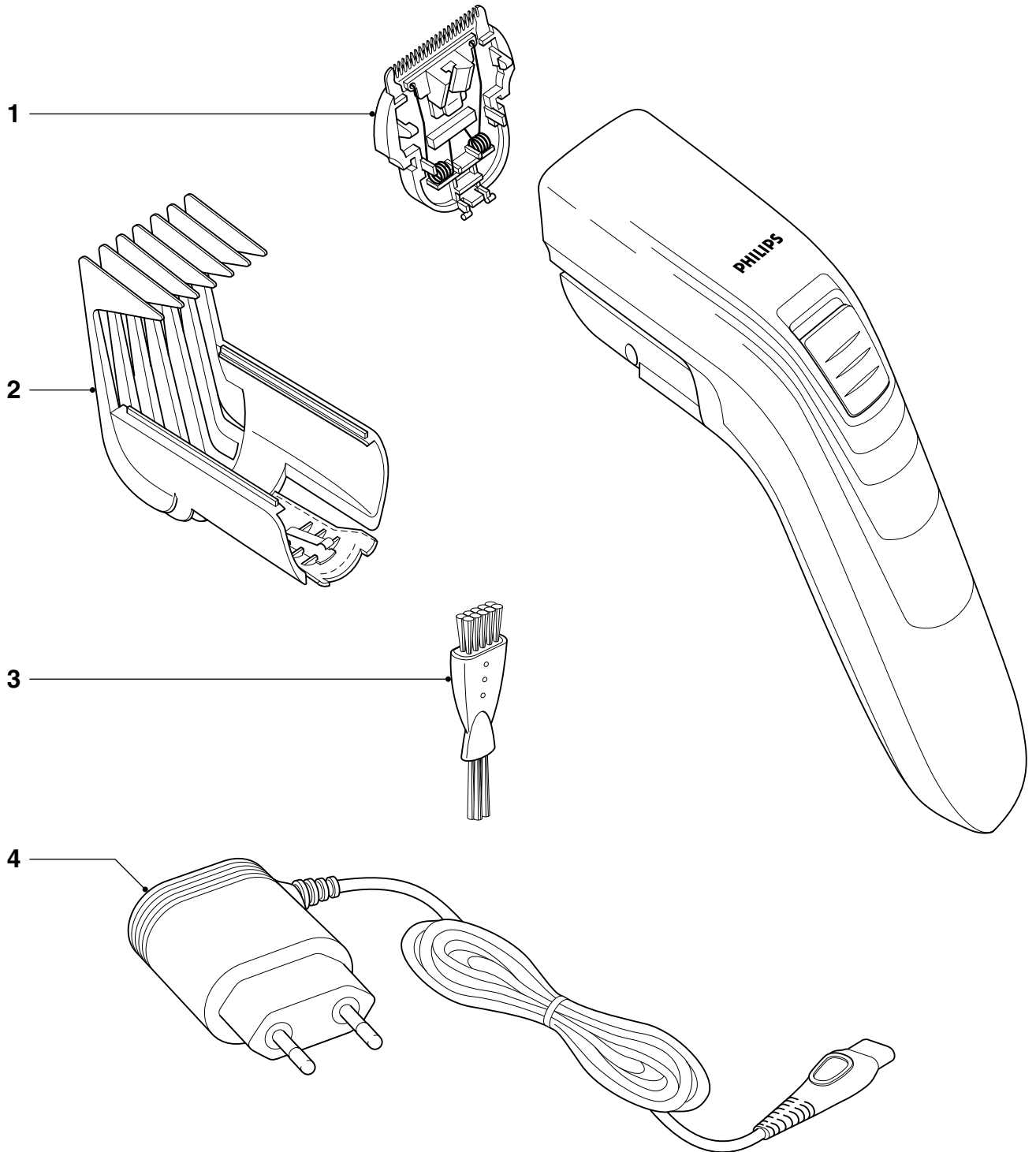

Pos	Service code	Description
1	4222 036 17510	Cutter
2	4222 036 17520	Comb
3	4222 036 02770	Brush
4	4222 036 04080	Power plug EUR
	4222 036 05160	Power plug NOR
	4222 036 05120	Power plug AUS/NZ
	4222 036 04090	Power plug GBR

Pos	Service code	Description
4	4222 036 05110	Power plug CAN/TW
	4222 036 03810	Power plug MEX
	4222 036 04850	Power plug KOR
	4222 036 03870	Power plug JAP
	4222 036 10320	Power plug PRC
	4222 036 03760	Power plug ARG